

# EG Magnetostrictive Level Transmitter Operation Manual (Four Wire)

## INSTALLATION RECOMMENDATION

1. Power supply 24Vdc±20%.
2. Please do not change magnetic float to avoid effect on measurement accuracy.
3. User can install the product directly without having to take off the float, when connection hole at site is bigger than float diameter.
4. Please take off the float before installation, when connection hole at site is smaller than float diameter.
5. Please install the float by specific direction (mark on the float has to be toward the product enclosure).
6. The stopper has to be fixed well on the stem score.
7. Please do not drop the magnetic float, to avoid magnet breakage inside the float.
8. Do not pressure the product with heavy weight, to bend the stem. If the stem is bent and can not work, please send back to us for calibration.
9. Package by bubble bag or foam is necessary to ensure safety during transportation.
10. Please do not open the product enclosure to assure measurement accuracy.

## INSTALLATION METHOD IF THE FLOAT HAS TO BE TAKEN OFF BEFORE INSTALLATION:

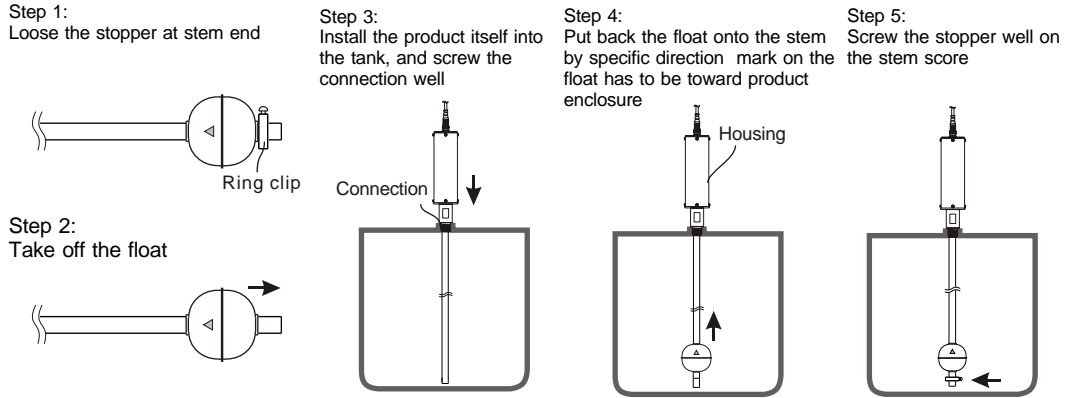

## DETERMINE THE LENGTH DURING ORDERING INSTRUCTION

Please refer below diagram for actual length of stem and the measurable length of the stem:  
 Order length (L)= Actual measurable length (X)+Length of float+Blanking zone (end)  
 = X+52+15  
 = 67+X(mm)

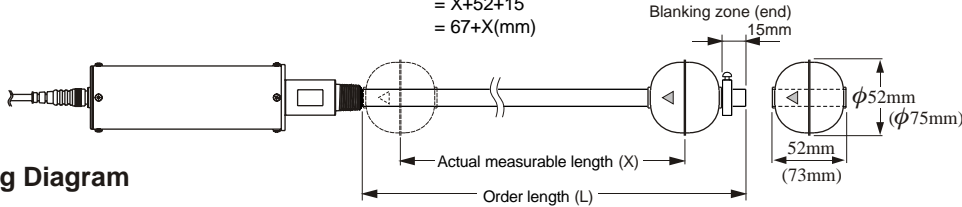

## Wiring Diagram

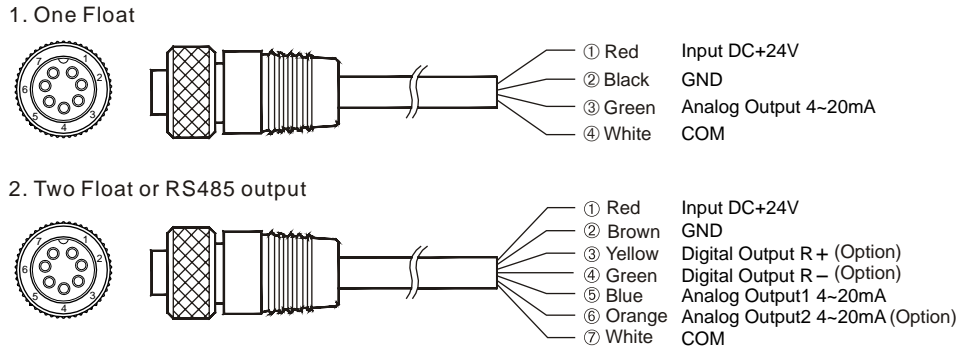

## Warranty:

Warranty 12 months after delivery. No fee such as testing, parts and maintenance will be charged in warranty. Any flaws caused by delivery can be filed to us within 7 days given related evidence. We will be responsible for repair or replacement.

Please send back the whole unit to us and pack well to prevent break-down during delivery. The following will be charged:

1. Out of warranty
2. Do not follow operation instruction in manual, or over product spec as indicated in catalogue.
3. Any cause by force majeure such as flood, earthquake, typhoon etc.

## ORDER INFORMATION-STANDARD

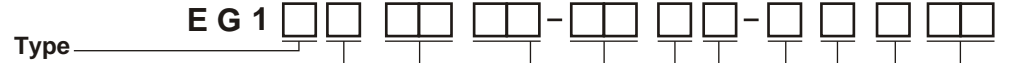

- Type
- 1: Standard Type
  - 2: Plastic coated Type
- Housing
- 0: Side conduit with ASI connector
  - 1: Top conduit with ASI connector
  - 2: Side conduit with ASI connector handle
  - 3: Side conduit with PG cable gland
  - 4: Top conduit with PG cable gland
- (Standard cable length 1M will be equipped.)

## Connection BQ: 1/2"PT (std.)

3---1-1/4"(32A)	M---5kg/cm <sup>2</sup>	Q---PT
B---1/2"(15A)	N---10kg/cm <sup>2</sup>	R---PF
C---3/4"(20A)	O---150 Lbs	T---BSP
D---1"(25A)	P---300 Lbs	U---NPT
E---1-1/2"(40A)	W---PN 10	V---GAS
F---2"(50A)	X---PN 16	S---Others
G---2-1/2"(65A)	Y---PN 25	
H---3"(80A)	Z---PN 40	
I---4"(100A)		
J---5"(125A)		
K---6"(150A)		
S---Others		

※ If installing directly (without removing float), the dimension of connection must be bigger than the external radius of the float (>1-1/2")

Float 1 Please see chart below

Float 2 Please see chart below

Code	Dimension	Material	S.G.	Code	Dimension	Material	S.G.
S4	φ52x52xD15	SUS316	0.75	F3	φ45x45xD20	PP	0.65
S5	φ75x73xD19	SUS316	0.6				

SS: Special Specification 00: No Float

## Analog Output 1

0: No A: 4~20mA (Bottom~Top) B: 20~4mA (Bottom~Tq)

## Analog Output 2

0: No A: 4~20mA (Bottom~Top) B: 20~4mA (Bottom~Tq)

## Digital Output

0: No 1: RS485

## Temperature SENSOR

0: No 1: One sensor in the end of the stem 2: One sensor at requested position

## Stem Length Range

S: 500mm~2000mm (Metal Stem: φ12.7, PP coated Stem φ17.2) Note: PP coated stem only available under 2M, standard metal material is SUS304  
 L: 2050mm~3000mm (Metal Stem: φ16)

## Stem Length

10:500~1000mm 20:1510~2000mm 30:2510~3000mm  
 15:1010~1500mm 25:2010~2500mm



**FineTek Co., Ltd.**

No.16, Tzuchiang St., Tucheng Industrial Park, Taipei Hsien, Taiwan  
 Tel: 886-2-22696789 Fax: 886-2-22686682  
 e-mail: info@fine-tek.com http://www.fine-tek.com

